



Industrial Specialties Mfg.

An ISO 9001:2008 Certified Company

4091 S. Eliot St., Englewood, CO 80110-4396 • 303-781-8486 FAX: 303-761-7939 • www.industrialspec.com

Tubing Size 1/16" - 1/4"
1/8" Flow Polypropylene

20PP Series Couplings

20PP Series couplings offer 1/8" flow, are produced from medical grade, gamma sterilizable polypropylene, and offer greater chemical resistance. 20PP couplings interconnect with all other 20AC and 20CB Series couplings as well as other similar industry thumb-latch couplings. These couplings are now available in New Legacy Almond and Modern Cool Grey colors.

2 STANDARD
COLORS



Performance Ratings:

- Operating Pressure: Vacuum to 120psi; (8.3bar)
- Temperature: 32°F to 160°F; (0°C to 71°C)
- Flow Capacity: 1/8" Size
- Sterilization: Gamma; 50 kGy irradiation max (see technical section for more detail)

Materials & Construction:

- Bodies & Terminations: Medical Grade Polypropylene
- Internal Valves: Medical Grade Polypropylene
- Internal Valve Springs: 316 Stainless Steel
- O-rings: Peroxide-cured EPDM (others available)
- Thumb-latch: Stainless Steel
- External Springs & Pins: Stainless Steel

20PP Series Air Flow

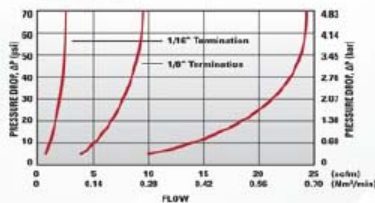

20PP Series Water Flow

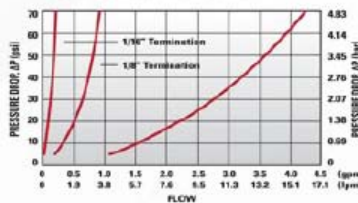

20PP Series Temperature

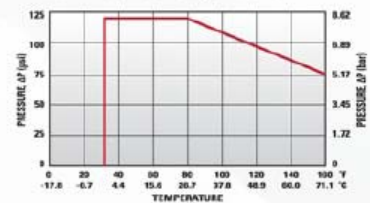

FLOW RATES

The data below shows liquid flow rates for LinkTech couplings. Each coupling combination was tested at 70°F (21°C).

C_v Values for 20PP Series Couplings

SOCKETS	20PPV-PE2-01	20PP-PE2-01	20PPV-PE2-02	20PP-PE2-02	20PPV-PE2-04	20PP-PE2-04	20PPV-PE9-04	20PPX-PE9-04	20PPV-PE1-02	20PPX-PE1-02	20PPV-PE4-04	20PPX-PE4-04
20PPV-SE2-01	0.02	0.02	0.03	0.03	0.03	0.03	0.03	0.03	0.03	0.03	0.03	0.03
20PP-S2-01	0.02	0.03	0.03	0.03	0.03	0.03	0.03	0.03	0.03	0.03	0.03	0.03
20PPV-SE2-04	0.03	0.03	0.16	0.22	0.21	0.26	0.17	0.23	0.19	0.25	0.24	0.27
20PP-S2-04	0.03	0.03	0.18	0.24	0.23	0.45	0.24	0.33	0.2	0.45	0.27	0.45
20PPV-SE3-02	0.03	0.03	0.14	0.17	0.15	0.19	0.15	0.19	0.18	0.18	0.15	0.19
20PP-S3-02	0.03	0.03	0.14	0.19	0.15	0.27	0.15	0.24	0.15	0.27	0.16	0.27
20PPV-SE3-04	0.03	0.03	0.16	0.22	0.21	0.26	0.17	0.23	0.19	0.26	0.16	0.25
20PP-S3-04	0.03	0.03	0.18	0.25	0.23	0.45	0.23	0.34	0.2	0.45	0.26	0.45
20PPV-SE8-04	0.03	0.03	0.16	0.2	0.17	0.22	0.17	0.21	0.17	0.21	0.18	0.22
20PP-S8-04	0.03	0.03	0.16	0.25	0.18	0.4	0.18	0.4	0.16	0.4	0.21	0.4
20PPV-SE1-02	0.03	0.03	0.16	0.24	0.2	0.28	0.18	0.27	0.2	0.26	0.24	0.26
20PP-S1-02	0.03	0.03	0.16	0.25	0.19	0.5	0.18	0.4	0.2	0.5	0.24	0.5
20PPV-SE1-04	0.03	0.03	0.17	0.25	0.23	0.3	0.19	0.3	0.21	0.27	0.24	0.29
20PP-S1-04	0.03	0.03	0.18	0.26	0.24	0.5	0.21	0.4	0.2	0.5	0.26	0.5

Specific coupling combination flow rates can be determined by using this formula:

$$Q = C_v \sqrt{\frac{\Delta P}{S}}$$

Q = Flow rate in gallons per minute
C_v = Average flow rates (see chart)
ΔP = Pressure drop across coupling (psi)
S = Specific gravity of liquid.

	PANEL OPENING	MAX PANEL THICKNESS	MIN PANEL THICKNESS
SOCKETS	Per Drawing	0.5"	0.05"
PLUGS	0.5"	0.3"	0.05"

PANEL NUT HEX SIZE	PANEL NUT THREAD
5/8"	1/2" - 24 UNS

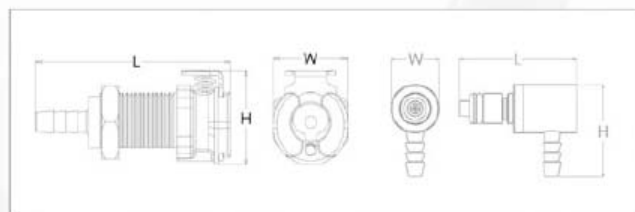
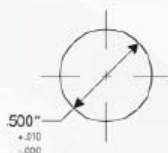

Reference Dimensions: L = Length, W = Width, H = Height

Worldwide Suppliers of Miniature Fluid and Pneumatic Circuitry Components